



# Architectural Metal

*custom fabrication for curtainwall and storefront applications*



[WWW.PAC-CLAD.COM](http://WWW.PAC-CLAD.COM)





Emmis Communications Corp. - Indianapolis, IN  
Architect: RATIO Architects, Inc.  
Glazing Contractor: ASI Limited  
Custom Fabrication: Ornamental Sill Flashing,  
Fascia Panels, Ornamental Tower



Marengo High School - Marengo, IL  
Owner: Board of Education  
Architect: Bradley & Bradley Architects  
General Contractor: IHC Construction Companies, LLC  
Contractor: Sullivan Roofing  
Color: Frisco White  
Profile: Composite Wall Panels

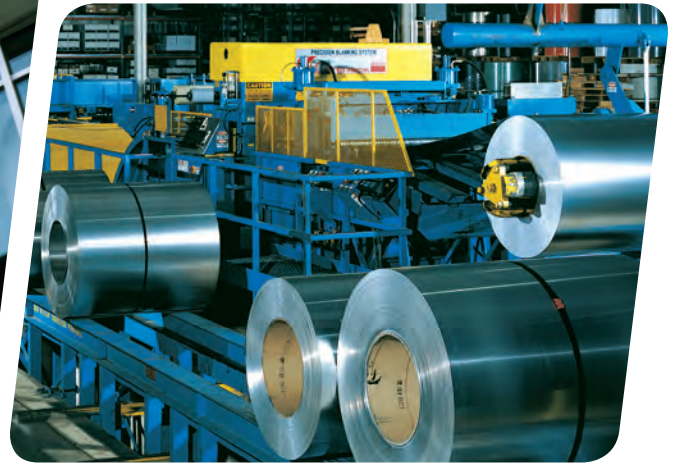

Petersen Aluminum Corporation was founded in 1965 as a metals service center to the architectural metal industry. Since its inception, Petersen Aluminum has transformed itself into a respected and recognized leader in architectural metal. With state-of-the-art equipment and a dedicated sales and management team, Petersen Aluminum has become an innovator in the metals industry. Petersen Aluminum is ready to apply its 50 years of experience to the glass industry.

With a complete line of metal products including column covers, corrugated panels, metal composite panels, metal plate panels, metal insulated spandrel panels, and custom heavy gauge fabrication, Petersen Aluminum Corporation is dedicated to making your projects run smoothly and cost-effectively.

In addition to our Chicago-based headquarters, we maintain full production facilities in Annapolis Junction, Maryland; Tyler, Texas; Acworth, Georgia and Fridley, Minnesota. With these locations, PAC-CLAD is able to provide high quality metal products at very competitive prices with dependable lead-times.

Technical assistance and service are provided by our staff and complimented locally by our nationwide organization of architectural representatives. We are prepared to offer assistance in design, budgeting, material and finish selection. As the scope of our products and capabilities are so wide, we encourage your inquiries.

Cover, left photo:  
Loeber Motors Mercedes-Benz - Lincolnwood, IL  
Architect: Valerio, Dewalt, Train Assoc. Inc.  
General Contractor: Pepper Construction  
Contractor: Sullivan Roofing, Inc.  
Profile: PAC-3000 CS  
Color: Anodic Clear

Cover, lower right photo:  
Streamwood Police Station - Streamwood, IL  
Architect: Sente Rubel Bosman Lee Architects  
General Contractor: M.A. Mortenson  
Contractor: All American Exteriors  
Product: PAC 1000C Series Column Covers & Beam Wraps  
Color: Clear Anodized

Cover, upper right photo:  
Mongue Residence - Milton, FL  
Owner: The Mongue Family  
Architect: Spencer Maxwell Bullock  
General Contractor: Biggs Green Construction  
Contractor: Specialty Contractors  
Profile: 7/8" Corrugated, Flush Panels & Flashings  
Color: Champagne Metallic & Copper Penny Metallic

# INDEX

Pages 3-4	Applications
Pages 5-6	Custom Fabrication
Pages 7-8	Exposed Fastener Panels
Page 9	Composite Wall Panels
Page 10	Column Covers
Page 11	PAC-CLAD Color Chart
Page 12	PAC-CLAD Availability
Page 13	Anodized Aluminum
Page 14	Copper and Stainless Steel Flat and Coil Stock

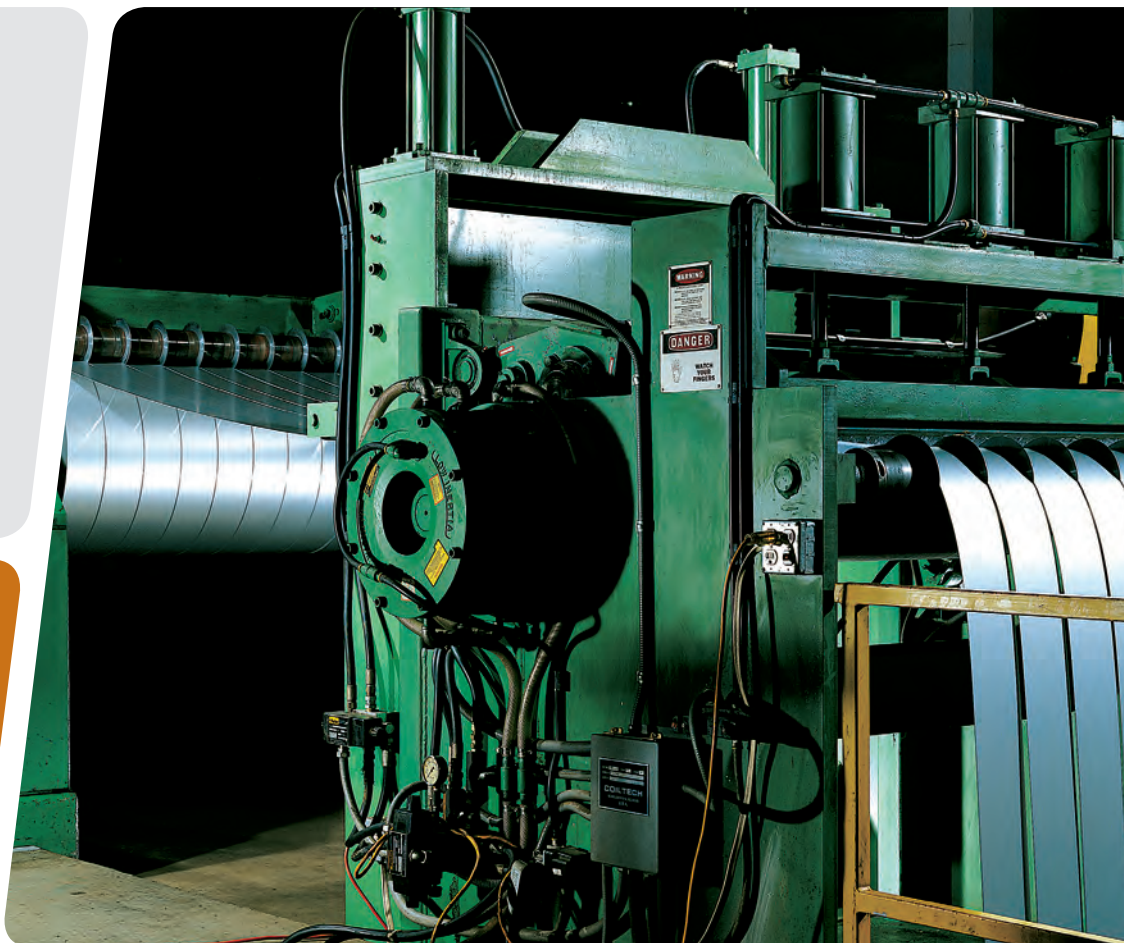



## APPLICATIONS



Heifer International - Little Rock, AR  
Owner: Heifer International  
Architect: Polk Stanley Rowland Curzon Porter Architects, LTD.  
Contractors: Ace Glass Co., Harness Roofing  
Color: Silver Metallic  
Profile: 7/8" Corrugated M - Panels, Coving



Beautiful Savior Lutheran Church - Plymouth, MN  
Architect: Cunningham Group Architecture  
Contractor: Atomic Sheet Metal  
Profile: Flat Seam Panels  
Color: Colonial Red, Weathered Zinc





Mongue Residence - Milton, FL  
 Owner: The Mongue Family  
 Architect: Spencer Maxwell Bullock  
 General Contractor: Biggs Green Construction  
 Contractor: Specialty Contractors  
 Profile: 7/8" Corrugated, Flush Panels & Flashings  
 Color: Champagne Metallic & Copper Penny Metallic



Sunrise Mainline Toll Plaza - Ft. Lauderdale, FL  
 Owner: Florida Turnpike Enterprise  
 Design: RS&H  
 Lead Contractor: MCM Corp.  
 Contractor: Allied Architectural Metals  
 Profile: 7/8" corrugated panels,  
 custom perforated .125 plate aluminum  
 Color: Silver Metallic



Pine Rest Postma Center for Worship & Education - Grand Rapids, MI  
 Architect: Integrated Architecture  
 General Contractor: Pioneer Construction  
 Contractor: Buist Sheet Metal Company  
 Color: Evergreen Copper, Classic Bronze & Platinum  
 Profile: PAC Flat Seam Panels, PAC Composite Panels



# CUSTOM FABRICATION

Understanding that it's all in the details puts Petersen Aluminum Corporation above and beyond in providing custom fabrication that exceeds the most exacting requirements. With state-of-the-art technology and insightful expertise, Petersen ensures unmatched quality and service from coil to finished part to complete even the most demanding project.

Our goal is simple: Provide precision-made parts to closely held tolerances to meet all of our customers' expectations. With the most advanced CNC shearing and bending equipment combined with over 50 years of industry experience, Petersen Aluminum offers superior innovation and flexibility in producing a wide range of custom architectural components.

## Fabrication Capabilities

- » Produce parts up to 20' long
- » Custom radius and bull nose parts
- » Available in custom heavy or light gauge parts
  - » Mill Finish Aluminum from .020" to .125"
  - » Galvanized Steel from 16 ga to 26 ga
  - » Stainless Steel from 16 ga to 26 ga
  - » Copper in 16 oz and 20 oz
- » Able to achieve custom-designed panels as well as simple angles
- » Ideal for curtain wall, glass and glazing industries
- » Precision shearing to meet exact dimensions

## Finishing Capabilities

- » Spray-applied non-standard or custom colors available in Kynar 500 formulation
- » Exterior grade and Class I architectural anodized finishes available



Page 6, upper photo:  
Sunrise Mainline Toll Plaza - Ft. Lauderdale, FL  
Owner: Florida Turnpike Enterprise  
Design: RS&H  
Lead Contractor: MCM Corp.  
Contractor: Allied Architectural Metals  
Profile: 7/8" corrugated panels,  
custom perforated .125 plate aluminum  
Color: Silver Metallic

Page 6, lower left photo:  
Steel Case Truck Well - Grand Rapids, MI  
Architect: URS  
General Contractor: Pioneer Construction  
Contractor: Metal-Tech  
Product: Curved Composite Panel  
Color: Classic Bronze

Page 6, lower right photo:  
GTE Building - Dallas, TX  
Architect: Gromatzky, Dupree & Associates  
General Contractor: H.C. Beck  
Glazing Contractor: Jennings Glass  
Products: Fascia Panels, Coping











Sunrise Mainline Toll Plaza - Ft. Lauderdale, FL  
Owner: Florida Turnpike Enterprise  
Design: RS&H  
Lead Contractor: MCM Corp.  
Contractor: Allied Architectural Metals  
Profile: 7/8" corrugated panels,  
custom perforated .125 plate aluminum  
Color: Silver Metallic

## EXPOSED FASTENER PANELS

Petersen Aluminum Corporation has provided the "M" and "R" exposed fastener panels in the past and has now increased its panel offerings even more. We have introduced the 7.2 Rib, the 7/8" Corrugated Panel, the 1/2" Corrugated Panel and additional coverage widths of the "M" and "R" Panel to the lineup. These profiles provide unmatched flexibility for use in roofing, wall and linear panel applications in a cost-efficient yet architecturally attractive metal panel.

PAC's line of corrugated panels are available in a full range of on-centers and gauges to meet the requirement of any application.

Petersen's family of corrugated panels can be produced perforated for a variety of exterior projects, such as equipment screens. Perforated corrugated panels are also highly suitable for interior acoustical applications as well. Contact a Petersen Aluminum representative regarding design capabilities for this product.

### Product Features

- » 20 year non-prorated finish warranty
- » Matching Screws and Rivets
- » Closure Strips Available
- » Precut Short Lengths (5'-0" minimum) (2'-0" on the M-42 and R-41)

### Material

- » 37 stocked colors (24 gauge steel)
- » 13 stocked colors (22 gauge steel)
- » 36 stocked colors (.032 aluminum)
- » 18 stocked colors (.040 aluminum)
- » Smooth and stucco embossed available
- » Galvalume Plus available



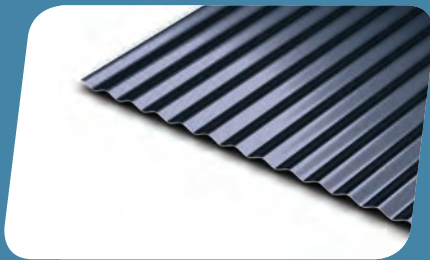

### 1/2" CORRUGATED PANEL

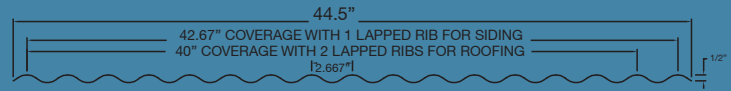

### 7/8" CORRUGATED PANEL

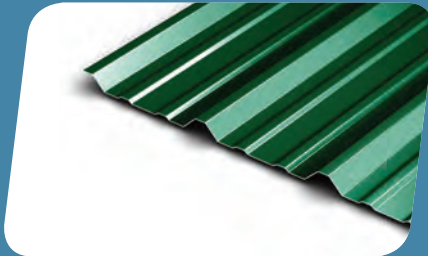
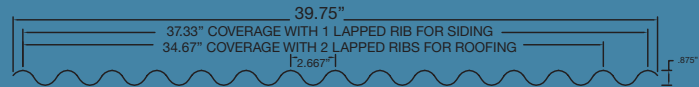

### R-41 PANEL\*\*

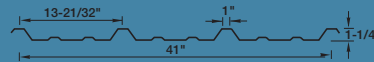

### R-36 PANEL

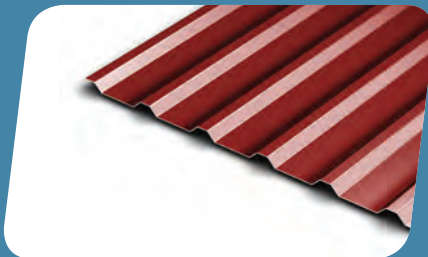

### M-42 PANEL\*\*

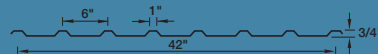

### M-36 PANEL\*\*

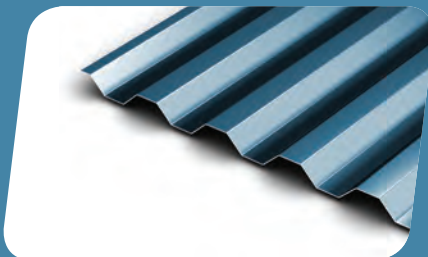

### 7.2 PANEL

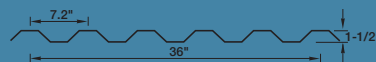

\*\*Note: The M-36, M-42 and the R-41 Panels are not intended for use in the construction of metal buildings or structural roof applications. Please consult with Petersen Aluminum regarding the application of this panel.

A complete specification is available online at [www.pac-clad.com](http://www.pac-clad.com).

**Upper Right:**  
Sunrise Mainline Toll Plaza - Ft. Lauderdale, FL

**Lower Right:**  
Heifer International - Little Rock, AR  
Owner: Heifer International  
Architect: Polk Stanley Rowland Curzon Porter Architects, LTD.  
Contractors: Ace Glass Co., Harness Roofing  
Color: Silver Metallic  
Profile: 7/8" Corrugated, M - Panels, Coping







Pine Rest Postma Center for Worship & Education -  
Grand Rapids, MI  
Architect: Integrated Architecture  
General Contractor: Pioneer Construction  
Contractor: Buist Sheet Metal Company  
Color: Evergreen Copper, Classic Bronze & Platinum  
Profile: PAC Flat Seam Panels, PAC Composite Panels

### Product Features

- » Available in a wide variety of colors and finishes
- » Precise fabrication to meet exacting tolerances
- » Rout-and-return fabrication
- » Welded corners available

### Material

- » 3mm, 4mm, 6mm - Composite
- » .063 - .125 Mill Finish Aluminum
- » Zinc, Copper, Stainless Steel, Anodized Aluminum

## COMPOSITE WALL PANELS

Petersen Aluminum offers another dimension in design flexibility with its series of Composite Wall panels. PAC's panel systems provide unmatched performance and stunning visual effects for any commercial or retail application.

The PAC-3000 CS panels are comprised of an .020 face and back skin thermobonded to a polyethylene or fire-retardant core. Panels are formed by a rout and return process utilizing computer controlled routing equipment. This state-of-the-art fabrication insures tight tolerances and accurate panel dimensions. Staggered angle clips mounted to the panel allow for each panel to be installed and adjusted individually.

The PAC-3000 RS is a rain-screen system that eliminates the use of caulk, utilizing clean reveals for an architecturally pleasing system. The system is constructed with aluminum composite material (ACM), available in a wide range of finishes and colors to complement any design scheme. Extrusions are fixed to the perimeter of the panel and nest into the extruded track which is attached to the substrate. The result is a free-floating panel installation since the panel is not fastened to the substrate.

The PAC-3000 AP panels provide a nearly endless selection of materials, finishes and configurations. Panels can be fabricated out of painted or anodized aluminum as well as stainless steel. Panel configurations can be customized to suit your application.

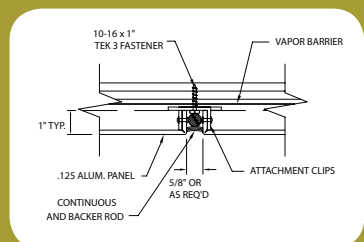
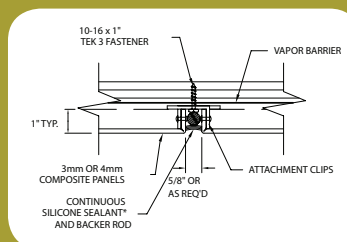
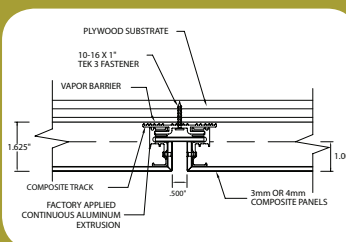



# COLUMN COVERS

## PAC-1000 & 2000 Series

The design of the PAC-1000 and 2000 “F” Series Column Covers allows for a clean, precise installation, revealing a hairline joint. The column sections are assembled using a rivnut/keyhole system to provide a tight inconspicuous vertical seam.

The PAC-1000 and 2000 “C” and “R” Series Columns are designed to leave a small open vertical reveal where the sections meet. Backer rod and caulk are applied to the vertical reveal joint to complete the installation of our “C” Series Column Cover. For the “F” Series Column, a metal channel filler is fabricated to fit into the vertical joint, and is set in sealant.

Your project may require column or section designs that are not shown here. Column Covers are available in 16 ga. stainless steel, .063 -.125 aluminum finished to a wide range of colors and anodized options, and composite material. Petersen Aluminum Corporation’s fabrication capabilities offer a great deal of flexibility and go far beyond what we can display on this page. Please contact us with your fabrication needs.

Streamwood Police Station - Streamwood, IL  
 Architect: Sente Rubel Bosman Lee Architects  
 General Contractor: M.A. Mortenson  
 Contractor: All American Exteriors  
 Product: PAC 1000C Series Column Covers & Beam Wraps  
 Color: Clear Anodized

## 1000 Series

Available in the following variations:

- » PAC-1000F (Flush Joint)
- » PAC-1000C (Caulk Joint)
- » PAC-1000R (Reveal Joint)

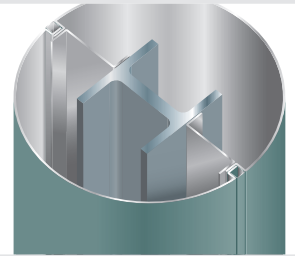

## 2000 Series

Available in the following variations:

- » PAC-2000F (Flush Joint)
- » PAC-2000C (Caulk Joint)
- » PAC-2000R (Reveal Joint)

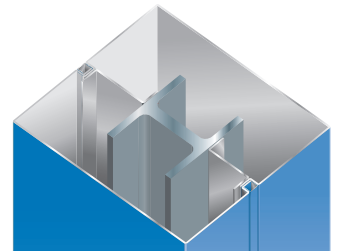

## Flush Joint

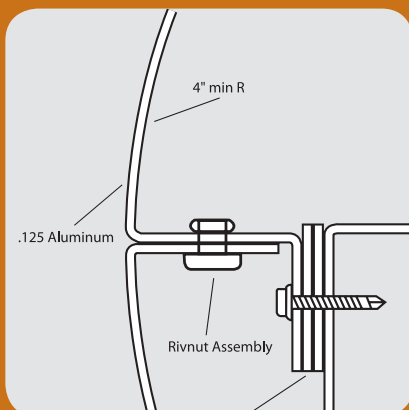

## Caulk Joint

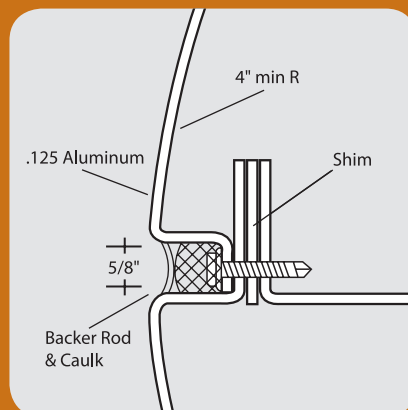

## Reveal Joint

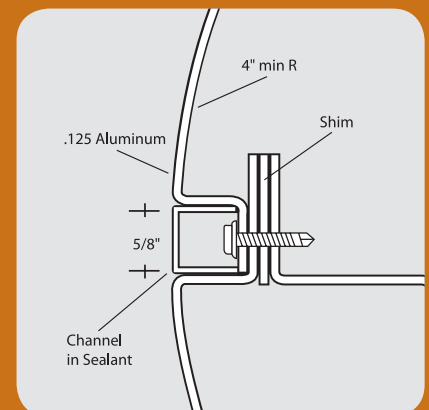



## STANDARD COLORS



Due to the limitations of the four color printing process, this color chart is not an accurate representation of our actual colors. Color charts and sample chips are available on request at no charge.

**RECYCLED CONTENT:**  
 PAC-CLAD Aluminum - 88%  
 » Post Consumer - 35%  
 » Post Industrial - 53%  
 PAC-CLAD Steel - 28 to 35%  
 » Post Consumer - 23%  
 » Post Industrial - 7.3%

\*Denotes PAC-CLAD Cool Colors

## METALLIC COLORS



### Trim

PAC-CLAD is available in prime quality aluminum (.032-.063), 24 gauge and 22 gauge G-90 galvanized steel finished with a PAC-CLAD Kynar 500®/Hylar 5000® finish (top side) and a polyester washcoat (bottom side). Other metals available include mill finish aluminum, copper, raw galvanized steel, terne-coated stainless steel, stainless, Galvalume Plus and anodized.

A strippable vinyl film can be applied for protection during fabrication and installation, if desired. Vinyl masking is recommended on all applications requiring extra handling. The vinyl must be removed immediately after installation.

### Warranty

Life expectancy is 20 years plus on Kynar-finished materials. A 20-year, non-prorated warranty covering color fade, chalking, and film integrity is available at no extra charge. Warranty terms vary slightly for Cardinal Red, Award Blue, Interstate Blue and embossed finishes.

### PAC-CLAD Metallics

Due to new technology, Petersen Aluminum can now supply metallic finishes with the economy of a one-pass, two-coat system. These colors are ideal for curtainwall and roofing applications. A PAC-CLAD Metallic 20 year, non-prorated finish warranty applies. This is a directional finish.

### \*Cool Colors

Petersen Aluminum Corporation is pleased to introduce PAC-CLAD Cool Colors: a new and updated color palette designed to improve the energy saving performance of our metal roofing products without compromising color selection. In creating this new product line, we worked with our coating supplier, The Valspar Corporation, to significantly broaden the range of PAC-CLAD colors that would meet ENERGY STAR®, LEED™ and/or cool roof certification requirements for solar reflectance and emissivity ratings.

This color chart includes solar reflectance and emissivity ratings for each color. It also includes availability by material and gauge. In addition, we are able to provide reflectance and emissivity ratings for custom color projects where required. If you have any questions regarding the information herein, please contact us at 1-800-323-1960; or visit our web site at [www.pac-clad.com](http://www.pac-clad.com).

### Energystar® Performance Criteria

Emissivity uses ASTM C1371/E408. Reflectivity uses ASTM E903/C1549.

### Installation

PAC-CLAD® can be cut, formed, nailed, screwed, or riveted using hand or power tools. Fabricate and install in accordance with drawings and normal sheet metal practices using hand or power tools.

Keep cutting edges sharp, clean, and properly aligned. Exercise care during fabrication and installation to avoid damage.

### Maintenance

Maintenance is not required. This finish is a member of the Teflon® family, and is self-cleaning. If cleaning is desired, it can be washed with a mild soap and water followed by a clean-water rinse.

### Samples

These color reproductions are as accurate as modern printing technology will permit. Free material samples are available on request.

### Textures

PAC-CLAD® is available with a smooth texture or a standard E-5 stucco embossed pattern, available at extra cost.

### Low Gloss/Low Sheen

This finish is a full Kynar 500®/Hylar 5000® finish, but is formulated in a low gloss/low sheen in order to minimize the appearance of oil-canning.



PAC-CLAD STANDARD	REFLECTIVITY	EMISSION	3 YEAR EXPOSURE	SRI*	STEEL 24GA. 22GA.		ALUMINUM .032 .040 .050 .063			
Almond	0.56	0.83	0.57	64	✓	✓	✓	✓	✓	
Arcadia Green	0.33	0.84	0.32	33	✓		✓			
Bone White	0.71	0.85	0.71	86	✓	✓	✓	✓	✓	✓
Cardinal Red	0.42	0.84	0.41	45	✓		✓		✓	
Charcoal	0.28	0.84	0.28	27	✓		✓		✓	
Cityscape	0.37	0.85	0.34	39	✓		✓	✓	✓	
Colonial Red	0.34	0.85	0.33	35	✓		✓	✓	✓	
Dark Bronze	0.27	0.85	0.26	26	✓	✓	✓	✓	✓	✓
Evergreen	0.27	0.85	0.25	26	✓		✓			
Granite*	0.36	0.84	0.35	37	✓	✓	✓	✓	✓	
Hemlock Green	0.30	0.85		30	✓	✓	✓		✓	
Hunter Green	0.26	0.84		24	✓		✓			
Mansard Brown	0.26	0.84	0.24	24	✓	✓	✓	✓	✓	
Medium Bronze	0.30	0.85	0.29	30	✓	✓	✓	✓	✓	✓
Midnight Bronze								✓		
Military Blue	0.29	0.84		28	✓		✓			
Musket Gray	0.32	0.84	0.31	32	✓	✓	✓		✓	
Patina Green	0.34	0.85	0.33	35	✓		✓			
Sandstone	0.51	0.83	0.51	57	✓	✓	✓	✓	✓	✓
Sierra Tan	0.38	0.85	0.35	40	✓	✓	✓	✓	✓	
Slate Blue	0.25	0.84		23	✓		✓			
Slate Gray	0.38	0.84	0.37	40	✓	✓	✓	✓	✓	
Stone White	0.61	0.86	0.59	72	✓	✓	✓	✓	✓	✓
Teal	0.26	0.85		24	✓		✓			
Terra Cotta	0.37	0.84	0.37	39	✓		✓		✓	
PAC-CLAD METALLIC										
Aged Copper	0.27	0.83	0.25	25	✓		✓		✓	
Champagne	0.45	0.78	0.41	57	✓		✓		✓	
Copper Penny	0.45	0.82	0.42	49	✓		✓	✓	✓	
Silver	0.53	0.80	0.51	59	✓		✓	✓	✓	
Weathered Zinc	0.27	0.80	0.27	23	✓		✓		✓	
Zinc	0.30	0.85	0.30	30	✓		✓		✓	
Galvalume Plus**	0.68	0.14	0.55	57	✓					
PAC-CLAD STANDARD COLORS (DO NOT MEET COOL ROOF REQUIREMENTS)										
Award Blue					✓		✓		✓	
Berkshire Blue*					✓					
Burgundy					✓		✓		✓	
Forest Green					✓	✓	✓	✓	✓	
Hartford Green					✓		✓	✓	✓	
Interstate Blue					✓		✓		✓	
Matte Black					✓		✓	✓	✓	✓

PAC-CLAD® Metallic finishes are available from stock at a moderate extra cost. PAC-CLAD® Copper Penny is a Non-Weathering finish.

Solar Reflectance Index calculated according to ASTM E-1980.

\*Low Gloss/Low Sheen

\*\*Acrylic coated, non-Kynar Finish.

**Energystar® Performance Criteria:** Emissivity uses ASTM C1371/E408. Reflectivity uses ASTM E903/C1549.

**Installation:** PAC-CLAD® can be cut, formed, nailed, screwed, or riveted using hand or power tools. Fabricate and install in accordance with drawings and normal sheet metal practices using hand or power tools. Keep cutting edges sharp, clean, and properly aligned. Exercise care during fabrication and installation to avoid damage.

**Maintenance:** Maintenance is not required. This finish is a member of the Teflon® family, and is self-cleaning. If cleaning is desired, it can be washed with a mild soap and water followed by a clean-water rinse.

**Samples:** These color reproductions are as accurate as modern printing technology will permit. Free material samples are available on request.

**Textures:** PAC-CLAD® is available with a smooth texture or a standard E-5 stucco embossed pattern, available at extra cost.

**\*Low Gloss/Low Sheen:** This finish is a full Kynar 500®/Hylar 5000® finish, but is formulated in a low gloss/low sheen in order to minimize the appearance of oil-canning.

**Technical Data for Kynar 500® / Hylar 5000® Coating:**

- Life Expectancy: 20 years exposure - Chalk: rating of 8 or better. Color: 5r (Hunter Units) change.
- Accelerated Weathering: (ASTM G-23 Type EH) 5,000 hours - Chalk: rating of 8 or better. Color: ≤5r (Hunter Units) color change.
- Humidity Resistance: (ASTM 2247) 2,000 hours - No change in pencil hardness.
- Salt Spray Resistance: (ASTM B 117) - 2,000 hours for Aluminum, creepage at scribe ≤1/32", no blisters. 2,000 hours for hot dipped Galvanized, creepage at scribe 1/8", few #8 blisters.
- Chemical/Acid Pollution Resistance: (ASTM D 1808) - Pass.
- Solvent Resistance: (NCCA procedure 11-18, no comparable ASTM test) - Pass.

- Formability: (ASTM D 3281 and ASTM D 1737) - Can be formed without film fracture using normal metal shop practices to a 1 to 2-T bend radius
- Hardness: (ASTM D 3363) - ≥F pencil hardness.
- Gloss: 30 ± 5 at 60s (low gloss/sheen available).
- Abrasion Resistance: (ASTM D 968) - Coefficient of 65±10.
- Adhesion: (ASTM D 3359 and NCCA procedure No. 11-5) - Pass.
- Impact Resistance: (ASTM D 2794 and NCCA Technical Bulletin No. 11-6) - 70 inch/lbs., no tape pick-off.
- Recycled Content
- PAC-CLAD Aluminum - 88% (Post Consumer: 35%; Post Industrial: 53%)
- PAC-CLAD Steel - 28 to 35% (Post Consumer: 23%; Post Industrial: 7.3%)



Sinai Samaritan Hospital - Milwaukee, WI  
 Architect: HGA Associates  
 General Contractor: Gruneau Project Development  
 Sheet Metal Fabricator: Speicalty Associates Inc.  
 Color: Light Bronze Anodized



## ANODIZED ALUMINUM

### PAC 500 Bronze Anodized Aluminum

Petersen Aluminum Corporation has recently added "two-step" anodizing equipment. This process, acquired through license from Alcan International Ltd., enables us to produce architectural bronzes and black in coil form.

The PAC 500 finish is accomplished through a progressive electrolytic process. The metal is first anodized in a sulphuric acid bath. The material then passes through an electrically charged bath of cobalt mineral salts. The finishing process is completed as the metal passes through a sealing tank. A complete range of bronze shades and black can be achieved through variation of the current through the coloring tank. PAC 500 is highly resistant to ultra-violet light.

The coil anodizing capability allows us to hold extremely tight control over color range. Control over color range makes PAC 500 the finish of choice for curtain wall, storefront and batten roofing applications where an anodized finish is desired. With anodized finishes, a color variance is to be expected from batch to batch. To minimize the color variance, please order enough sheet or coil to complete the project.

### PAC 300 Clear Anodized Aluminum

PAC 300 Clear Anodized Aluminum consists of anodized quality 5005-H34 aluminum sheet, giving a .0003 thick clear anodized coating. Coil anodizing allows for exceptional control over uniformity of appearance. PAC 300 anodized aluminum is stocked in gauges .032 -.125.

### ANODIZED AVAILABILITY CHART

	.032	.040	.050	.063	.080	.125
<b>PAC 500</b>						
Bright Clear		✓				
Bright Gold		✓				
Champagne	✓	✓	✓	✓		
Light Bronze	✓	✓	✓	✓		
Medium Bronze	✓	✓	✓	✓		
Dark Bronze	✓	✓	✓	✓	✓	✓
Black	✓	✓	✓	✓	✓	✓
<b>PAC 300</b>						
Clear	✓	✓	✓	✓	✓	✓



## COPPER AND STAINLESS STEEL

Petersen Aluminum Corporation has expanded into the copper and stainless steel markets. We are now stocking Stainless Steel Type 304 2B and 16 oz and 20 oz Cold Rolled Copper sheet and coil. Petersen Aluminum offers a variety of stainless steel and copper to meet your project requirements. Please consult your local Petersen representative for a full range of product availability.

### Sheets

- » 16 oz. x 24 x 96
- » 16 oz. x 24 x 120
- » 16 oz. x 36 x 96
- » 16 oz. x 36 x 120
- » 16 oz. x 48 x 120
- » 20 oz. x 24 x 120
- » 20 oz. x 36 x 120

### Coil

- » 16 oz. x 10-1/2"
- » 16 oz. x 11-7/8"
- » 16 oz. x 13-3/4"
- » 16 oz. x 15"
- » 16 oz. x 15-7/8"
- » 16 oz. x 22"
- » 16 oz. x 24"
- » 20 oz. x 11-7/8"
- » 20 oz. x 15"

### Stainless Steel

- » 304 2D
- » 304 2B
- » 304 2B Polished



## FLAT AND COIL STOCK

In addition to offering the industry's widest selection of Kynar finishes in steel and aluminum, Petersen Aluminum also offers pre-painted aluminum and mill finish sheet and coil in a variety of gauges. With state-of-the-art cut to length and slitting equipment, Petersen can provide flat and coil stock to the most exacting specifications.

### PAC Painted Sheet - Acrylic

Dark Bronze, Medium Bronze, White, Blue, Yellow, Brown, Black and Red painted sheet is stocked for immediate delivery. PAC pre-painted aluminum may be sheared and formed over a 1-1/2 to 2 T bend radius. Life expectancy is 10 years plus.

This material is highly suitable for a wide range of applications, including signage and the race car industry. No warranty is available on this product.

### Mill Finish

Anodizing quality 5005-H34, as well as 3003-H14, is stocked in gauges .032 to .125 for all applications that require fabrication and post-finishing.

### Textured Sheet

Most finishes stocked by Petersen are available in an E-5 stucco embossed pattern. Gauges .063 and over are not available in this pattern. Samples are available on inquiry. Petersen also stocks in limited gauges and finishes perforated sheets for projects requiring ventilation. Check with the local factory for perforated sheet options.

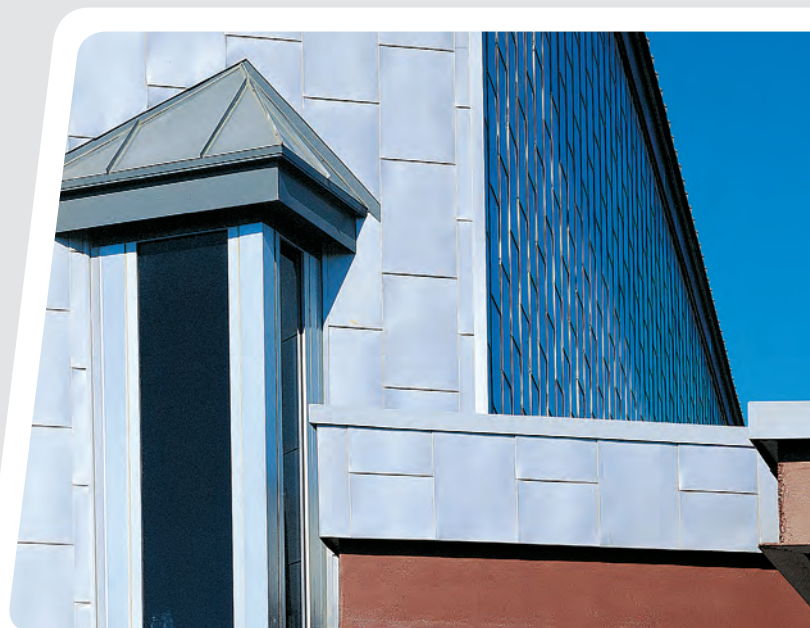

Calvary Church - Naperville, IL  
Owner: Calvary Church  
General Contractor: Paul H. Schwendener  
Roofing Contractor: James Mansfield & Sons, Inc. and A-1 Roofing  
Profile: Snap-Clad & Flat Seam Panels  
Color: Musket Gray Kynar & TCS II





- » PAC-CLAD Aluminum
- » PAC-CLAD Steel
- » Tite-Loc Panels
- » SNAP-CLAD™
- » Redi-Roof®
- » Integral Panels
- » Snap-on Panels
- » Exposed Fastener Panels
- » Flush Panels
- » Soffit Panels
- » Edge-Loc Panels
- » Solar Panels
- » Flashing and Trim
- » Coping and Gravel Stops
- » Anodized Aluminum
- » Copper and Stainless Steel
- » Column Covers
- » Composite Panels

## Petersen Aluminum Corporation

*Specify Petersen... you have our assurance of quality.*

**HQ:** 1005 Tonne Road  
Elk Grove Village, IL 60007  
P: 800-PAC-CLAD  
F: 800-722-7150

9060 Junction Drive  
Annapolis Junction, MD 20701  
P: 800-344-1400  
F: 301-953-7627

10551 PAC Road  
Tyler, TX 75707  
P: 800-441-8661  
F: 903-581-8592

350 73rd Ave., NE, Ste 1  
Fridley, MN 55432  
P: 877-571-2025  
F: 866-901-2935

102 Northpoint Pkwy Ext, Bldg 1, Ste 100  
Acworth, GA 30102  
P: 800-272-4482  
F: 770-420-2533

Visit our website to download product CAD drawings and much more:  
[WWW.PAC-CLAD.COM](http://WWW.PAC-CLAD.COM)

In presenting this catalog, we serve only in an advisory capacity and can undertake no liability. Consideration should be given on local conditions in selecting materials and panel profiles. The photographs appearing in this catalog show typical PAC-CLAD applications.

Kynar 500® is a registered trademark of Atochem Inc. and Hylar 5000® is a trademark of Ausimont USA Inc.

