

PAC-TITE ANGULAR FASCIA

FULLY ADHERED OR MECHANICALLY ATTACHED SINGLE-PLY VERSION

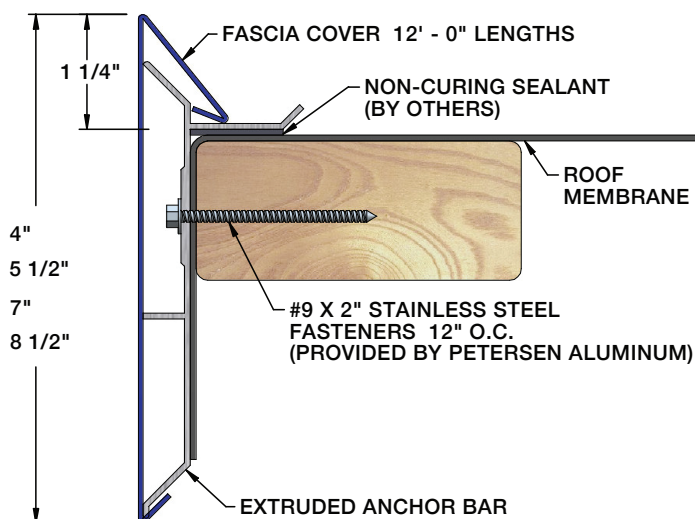

SIZES

Face Heights	Nailer Coverage
4"	1 Nailers
5 1/2"	2 Nailers
7"	3 Nailers
8 1/2"	4 Nailers

PRODUCT FEATURES

- ▶ Unmatched uplift protection in roof edge applications
- ▶ Combines superior strength and aesthetics with ease of installation
- ▶ Meets stringent performance requirements
- ▶ Non-penetrating design eliminates need for stripping in/heat welding
- ▶ Superior watertight integrity of the installation
- ▶ Extruded aluminum anchor bar securely terminates the membrane
- ▶ Extensively tested to exceed industry standards
- ▶ Pre-punched holes for precise fastener placement and quick installation
- ▶ Slotted holes allow for thermal movement
- ▶ Lifetime, 215 mph wind warranty available

- ▶ Wide variety of colors and finishes
- ▶ Convenient 12' Lengths
- ▶ Custom and radius capabilities available
- ▶ Reusable and recyclable for reinstallation
- ▶ Ideal for parapet applications instead of coping

MATERIALS

- ▶ 48 Stocked PAC-CLAD Finishes (24 gauge steel)
- ▶ 26 Stocked PAC-CLAD Finishes (.040 aluminum)
- ▶ Mill Finish Aluminum (.040 aluminum)
- ▶ Clear and Colored Anodized (.040 aluminum)

ACCESSORIES

- ▶ Miters (90 Degrees and Non-90 Degrees)

- ▶ Scuppers (Downspout, Spillout and Overflow)
- ▶ Drainage Components

TESTING

- ▶ ANSI/SPRI ES-1 Standard to a design pressure of 290 lbs/ft² to comply with the International Building Code
- ▶ Factory Mutual approved
- ▶ Miami-Dade Approved to comply with the "High Velocity Hurricane Zone" of the Florida Building Code

WARRANTY

A Lifetime 215 mph warranty is available. It covers replacement or repair of any portion of the roof edge system that has failed due to a defect in the supplied materials. The warranty covers the roof edge for the lifetime of the roof on which it was originally installed.