

# PAC-TITE WT FASCIA

## FULLY ADHERED OR MECHANICALLY ATTACHED SINGLE-PLY VERSION



### SIZES

Face Heights	Nailer Coverage
4"	1 Nailers
5 1/2"	2 Nailers
7"	3 Nailers

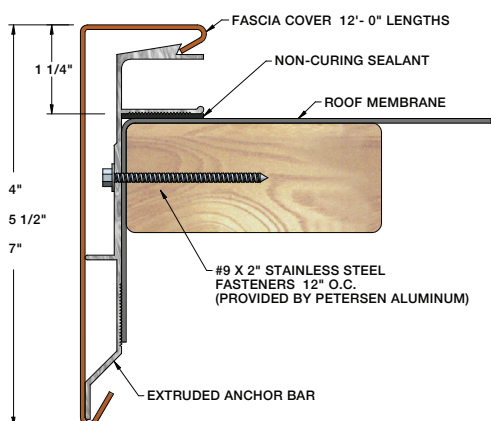

### PRODUCT FEATURES

- ▶ Unmatched uplift protection in roof edge applications
- ▶ Ability to use heavier gauges for smaller face sizes
- ▶ Concealed splice plates allow for cleaner design
- ▶ Meets stringent performance requirements
- ▶ Non-penetrating design eliminates need for stripping in/heat welding
- ▶ Superior watertight integrity of the installation
- ▶ Extruded aluminum anchor bar securely terminates the membrane
- ▶ Extensively tested to exceed industry standards
- ▶ Pre-punched holes for precise fastener placement and quick installation
- ▶ Slotted holes allow for thermal movement
- ▶ Includes anchor bar EPDM splice plates and required fasteners
- ▶ Lifetime, 215 mph wind warranty available
- ▶ Wide variety of colors and finishes
- ▶ Convenient 12' Lengths
- ▶ Custom and radius capabilities available
- ▶ Reusable and recyclable for reinstallation

### MATERIALS

- ▶ 17 Stocked PAC-CLAD Finishes (22 gauge steel)
- ▶ 21 Stocked PAC-CLAD Finishes (.050 aluminum)
- ▶ 6 Stocked PAC-CLAD Finishes (.063 aluminum)
- ▶ Mill Finish Aluminum (.050 & .063 aluminum)
- ▶ Clear and Colored Anodized (.050 & .063 aluminum)

### ACCESSORIES

- ▶ Miters (90 Degrees and Non-90 Degrees)
- ▶ Scuppers (Downspout, Spillout and Overflow)
- ▶ Drainage Components

### TESTING

ANS/SPRI/FM 4435/ES-1 Standard to comply with the International Building Code

### WARRANTY

A Lifetime 215 mph warranty is available. It covers replacement or repair of any portion of the roof edge system that has failed due to a defect in the supplied materials. The warranty covers the roof edge for the lifetime of the roof on which it was originally installed.