

PAC EXTENDED SNAP EDGE FASCIA

FULLY ADHERED OR MECHANICALLY ATTACHED SINGLE-PLY VERSION

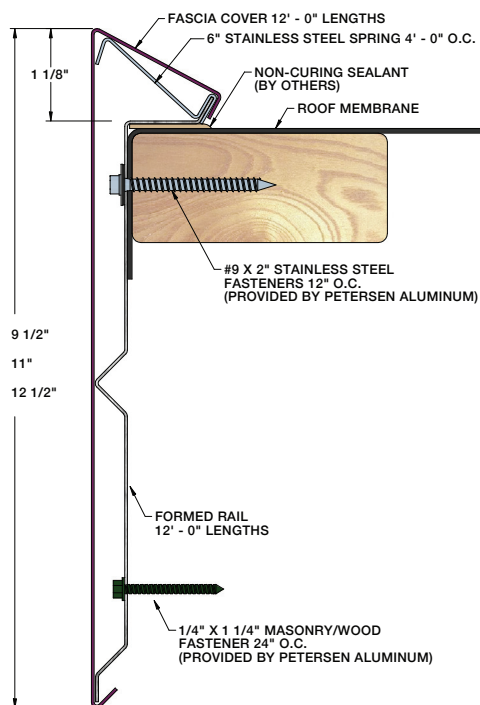

SIZES

Face Heights	Nailer Coverage
9 1/2"	5 Nailers
11"	6 Nailers
12 1/2"	7 Nailers

PRODUCT FEATURES

- ▶ Quick lead times to keep projects on schedule
- ▶ Economically priced and easy to install
- ▶ Available in face height up to 12"
- ▶ Pre-punched, slotted holes for precise fastener placement
- ▶ Wide variety of colors and finishes
- ▶ Convenient 12' lengths
- ▶ Reusable and recyclable material
- ▶ Efficient design eliminates need for stripping in/heat welding
- ▶ Factory fabricated miters and scuppers available
- ▶ All fasteners are included

MATERIALS

- ▶ 22 gauge steel
- ▶ .050 aluminum
- ▶ .063 aluminum
- ▶ Mill Finish Aluminum (.050 & .063 aluminum)
- ▶ Clear and Colored Anodized (.050 & .063 aluminum)

ACCESSORIES

- ▶ Miters (90 Degrees and Non-90 Degrees)
- ▶ Scuppers (Downspout, Spillout and Overflow)
- ▶ Drainage Components

TESTING

- ▶ ANSI/SPRI/FM 4435 ES-1 Standard to comply with the International Building Code
- ▶ Factory Mutual approved

WARRANTY

A 5-Year Workmanship Warranty is available. It covers replacement or repair of products that are defective in material or workmanship.