



PAC-CLAD®

P E T E R S E N

A **CARLISLE** COMPANY



Perimeter/Roof Edge Systems

TABLE OF CONTENTS

3-4 PAC-CLAD PRODUCT RANGE AND APPLICATIONS

5 PAC-CLAD COLOR CHART

6 PAC-TITE ANGULAR FASCIA



BUM



FA

7 PAC-TITE WT FASCIA



BUM



FA

8 PAC-TITE WT EXTENDED FASCIA



BUM



FA

9 PAC-TITE WT CANTED FASCIA



Extended

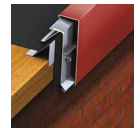

Standard

10 PAC-LOC FASCIA



2000



3000

11 PAC SNAP EDGE FASCIA



BUM



FA



SB

12 PAC EXTENDED SNAP EDGE FASCIA



BUM



FA

13 PAC-TITE COPING



Existing Slope



Flat



Tapered

14 PAC-CONTINUOUS CLEAT COPING



15 PAC-TITE GOLD COPING



On the cover:
Cougar Place Replacement Housing, University of Houston,
Houston, TX
Architect: PageSouthernlandPage
General Contractor: SpawGlass
Installer: Gulf Star Roofing and Sheet Metal
Material: PAC Precision Series Wall Panels HWP, Flush Panels,
PAC Continuous Cleat Coping
Color: Silver

BUM - Built-Up/Modified FA - Fully Adhered/Mechanically Attached Single-Ply SB - Stone Ballast Single-Ply

PAC-CLAD® PRODUCT RANGE

Petersen's perimeter/roof edge product line provides the complete system to ensure a clean, sure-fitting product while eliminating the need for field fabrication. All perimeter systems are produced in 12'-0" lengths for an estimated 20 to 40 percent savings in material handling over the typical 8' or 10' lengths. Petersen's perimeter systems are competitively priced while providing superior strength, aesthetics and ease of installation. These products assure that customers are meeting, and in most cases exceeding, specifications.

Petersen Aluminum Corporation (PAC), a Carlisle company, was founded in 1965 as a metals service center to the architectural metal industry. Petersen provides products of the highest possible quality within reliable, dependable lead times. Petersen's strong national sales base allows for large inventories and cost economies for customers.

Headquartered in Elk Grove Village, Illinois, located just outside of Chicago, Petersen also operates full production facilities in Annapolis Junction, Maryland; Tyler, Texas; Phoenix, Arizona and Acworth, Georgia plus a regional sales office in Andover, Minnesota. In addition to the information found in this catalog, Petersen maintains an extensive website at pac-clad.com. This catalog is available in standard 3-ring binder, as well as digital format and within our e-binder at pac-clad.com.

Technical assistance and service are provided by Petersen staff and complemented locally by a nationwide organization of architectural representatives. Petersen is prepared to offer assistance in material selection, finish specification and budgeting. As the scope of Petersen's applications is so wide, inquiries are encouraged.

PAC-CLAD ARCHITECTURAL SHEET AND COIL

PAC-CLAD is a versatile prefinished sheet metal coating of 70% polyvinylidene fluoride (PVDF) that is applied to G-90 galvanized steel, Galvalume steel or prime quality aluminum. Originally developed for use in abrasive environments, PAC-CLAD has proven to be ideally suited for applications in roofing, wall, curtainwall, storefront and trim applications. PAC-CLAD is now available in 45 colors carefully selected to complement a range of building materials.

PAC-CLAD ACCESSORIES

Petersen fabricates a wide range of roofing accessories from its stocked PAC-CLAD colors and gauges. Trim, gutters and downspouts can be produced in 45 standard PAC-CLAD colors.

DESCRIPTIONS HEREIN ARE NOT WARRANTIES

The descriptions in this catalog of Petersen Aluminum Corporation products are given for informational purposes only, and are not warranties. No express warranties are contained in this catalog. Petersen Aluminum Corporation does not build or design buildings. It acts solely as a supplier of materials, and assumes no responsibility for the proper use or installation of those materials, nor for the suitability of those materials for any specific use or for compliance with local building codes.



PAC-CLAD® APPLICATIONS



PAC-CLAD® COLOR CHART

TRIM

PAC-CLAD products are available in prime quality aluminum (.032 - .063), 24 gauge G-90 galvanized steel and 22 gauge Galvalume steel, finished with a 70% PVDF (Kynar) finish on the top side, with a washcoat on the bottom. Other metals available include mill finish aluminum, bare galvanized steel, stainless steel, Galvalume Plus and anodized aluminum.

A strippable vinyl film can be applied to coil, flat sheet or fabricated parts to protect painted surfaces. Vinyl masking is recommended where extra handling is expected. NOTE: Film must be removed immediately after installation.

FINISH WARRANTY

Life expectancy is 30-years plus on 70% PVDF-finished materials. A 30-year, non-prorated warranty covering color fade, chalking and film integrity is available at no extra charge. Warranty terms vary slightly for Cardinal Red, Award Blue, Weathered Steel and Weathered Copper.

PAC-CLAD METALLICS

Petersen can supply metallic finishes with the economy of a one-pass, two-coat system at a moderate additional cost. These colors are ideal for all building envelope applications. A PAC-CLAD metallic 30-year, non-prorated finish warranty applies. Proper orientation is required as this is a directional finish.

COMMITMENT TO SUSTAINABILITY

PAC-CLAD products provide unmatched aesthetics and performance, plus an element of sustainability. Where possible, Petersen products include a high percentage of recycled material, which lowers their environmental footprint. Additionally, PAC products are 100% recyclable which may reduce the solid waste stream to landfills.

Petersen also offers the industry's widest range of 45 colors, most of which feature outstanding SRI (Solar Reflectance Index) values for improved cooling and energy savings performance. PAC-CLAD offers 35 finishes that are rated by the Cool Roof Ratings Council, and 31 colors that are Energy Star®-approved. In addition, 30 PAC-CLAD finishes have an SRI of 29 or higher for steep slope roofs, to allow a building to qualify for credits in the U.S. Green Building Council's Leadership in Energy and Environmental Design (LEED) Green Building Rating System. Refer to pacgreeninfo.com for more information on sustainable cool metal roofing.

SHERWIN-WILLIAMS
Coil Coatings

Petersen Aluminum has been a proud partner with Sherwin-Williams Coil Coatings since 1972

NOTE: Colors below are not exact representations of actual PAC-CLAD colors. Ask a PAC representative for a color-chip chart or painted metal samples before making final color selection.

STANDARD COLORS

Patina Green*	Teal*	Hemlock Green*	Forest Green	Dark Bronze*	Midnight Bronze	Mansard Brown*
Arcadia Green*	Hartford Green	Evergreen*	Hunter Green*	Burnished Slate*	Aged Bronze*	Burgundy
Military Blue*	Berkshire Blue	Pacific Blue* (aka Slate Blue)	Medium Bronze*	Terra Cotta*	Colonial Red*	Cardinal Red*
Interstate Blue	Award Blue	Charcoal*	Cityscape*	Sandstone*	Granite*	Sierra Tan*
Matte Black	Graphite*	Musket Gray*	Slate Gray*	Bone White*	Stone White*	Almond*

* Denotes PAC-CLAD Cool Color

PREMIUM COLORS

Anodic Clear*	Siversmith*
Silver*	Champagne*
Weathered Zinc*	Zinc*
Copper Penny*	Aged Copper*
Weathered Copper	Weathered Steel

PAC-TITE ANGULAR FASCIA



The PAC-TITE line of roof edge systems provides uplift protection for single-ply and built up/modified roof systems. PAC-TITE Angular Fascia utilizes 24 gauge steel and .040 aluminum to form the ideal solution in roof edge applications, meeting stringent performance requirements.

A non-penetrating design eliminates the need for stripping in and heat welding, maintaining the watertight integrity of the installation. PAC-TITE Angular Fascia features an extruded aluminum anchor bar to securely terminate the membrane for added installation flexibility.

TWO VERSIONS AVAILABLE

Two versions of PAC-TITE Angular Fascia are available and have been extensively tested to meet ANSI-SPRI/FM 4435/ES-1 and FM Approvals: Fully Adhered/Mechanically Attached Single-Ply (FA); and Built-Up/Modified (BUM). Additionally, PAC-TITE Angular Fascia is backed by a Lifetime 215 mph wind warranty to ensure long-term, worry-free performance.

PAC-TITE Angular Fascia features pre-punched holes which not only provide quicker installation for labor savings, but are slotted to allow for thermal movement for guaranteed long-term performance.

PRODUCT FEATURES

- ▶ Superior, efficient design for ease of installation
- ▶ Pre-punched, slotted holes for precise fastener placement
- ▶ Extensively tested for reliable long-term performance
- ▶ Welded corners and scuppers available
- ▶ Wide variety of colors and finishes
- ▶ Convenient 12' lengths
- ▶ Reusable and recyclable material
- ▶ Custom and radius capabilities available

MATERIAL

- ▶ 43 Stocked PAC-CLAD Finishes (24 gauge steel)
- ▶ 22 Stocked PAC-CLAD Finishes (.040 aluminum)
- ▶ Mill Finish Aluminum (.040 aluminum)
- ▶ Clear and Colored Anodized

TESTING

- ▶ ANSI-SPRI/FM 4435/ES-1 Standard (design pressure of 290 lbs/ft²)
- ▶ Miami-Dade approved to comply with the "High Velocity Hurricane Zone" of the Florida building code
- ▶ Factory Mutual approved

WARRANTY

A Lifetime 215 mph warranty is available. It covers replacement or repair of any portion of the roof edge system that has failed due to a defect in the supplied materials. The warranty covers the roof edge for the lifetime of the roof on which it was originally installed.

FULLY ADHERED/MECHANICALLY ATTACHED SINGLE-PLY (FA)

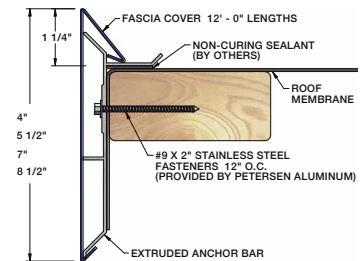

Face Heights	4"	5 1/2"	7"	8 1/2"
Nailer Coverage	1 Nailers	2 Nailers	3 Nailers	4 Nailers

BUILT-UP/MODIFIED (BUM)

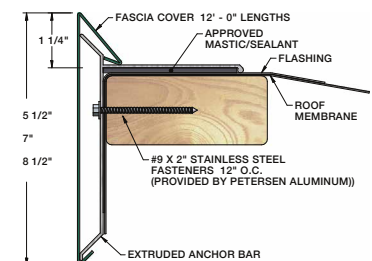

Face Heights	5 1/2"	7"	8 1/2"
Nailer Coverage	1 Nailers	2 Nailers	4 Nailers

PAC-TITE WT FASCIA

PAC-TITE WT Fascia has been specifically designed to meet architectural and industry demands to allow for the smaller face height in heavier gauge covers such as .050 and .063 aluminum, while delivering superior strength with ease of installation.

Heat welding and stripping in are no longer necessary due to our non-penetrating design. An extruded aluminum anchor bar securely terminates the membrane. This bar is stocked and available for quick delivery.

TWO VERSIONS AVAILABLE

Both versions of PAC-TITE WT Fascia are available and have been extensively tested to meet ANSI-SPRI/FM 4435/ES-1 Standards to comply with the International Building Code: Fully Adhered/Mechanically Attached Single-Ply (FA); and Built-Up/Modified (BUM). Additionally, PAC-TITE WT Fascia is backed by a Lifetime 215 mph wind warranty to ensure long-term, worry-free performance.

PAC-TITE WT Fascia features pre-punched holes which not only provide quicker installation for labor savings, but are slotted to allow for thermal movement for guaranteed long-term performance. Interlocking, concealed splice plates prevent splice plate migration for a more architecturally pleasing finish.

FULLY ADHERED/MECHANICALLY ATTACHED SINGLE-PLY (FA)

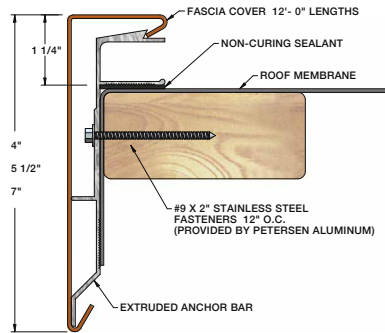

Face Heights	4"	5 1/2"	7"
Nailer Coverage	1 Nailers	2 Nailers	3 Nailers

BUILT-UP/MODIFIED (BUM)

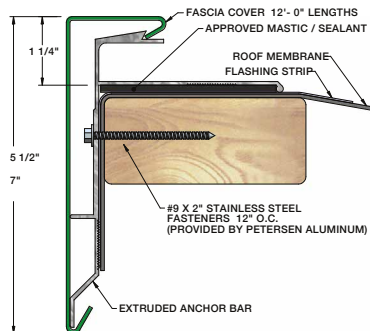

Face Heights	5 1/2"	7"
Nailer Coverage	2 Nailers	3 Nailers

PRODUCT FEATURES

- ▶ Superior, efficient design for ease of installation
- ▶ Pre-punched, slotted holes for precise fastener placement
- ▶ Welded corners and scuppers available
- ▶ Wide variety of colors and finishes
- ▶ Convenient 12' lengths
- ▶ Reusable and recyclable material
- ▶ Custom and radius capabilities available

MATERIAL

- ▶ 16 stocked PAC-CLAD Finishes (22 gauge steel)
- ▶ 29 Stocked PAC-CLAD Finishes (.050 aluminum)
- ▶ 6 Stocked PAC-CLAD Finishes (.063 aluminum)
- ▶ Mill Finish Aluminum (.050 & .063 aluminum)
- ▶ Clear and Colored Anodized (.050 & .063 aluminum)

TESTING

- ▶ ANSI/SPRI/FM 4435/ES-1 Standard to comply with the International Building Code

WARRANTY

A Lifetime 215 mph warranty is available. It covers replacement or repair of any portion of the roof edge system that has failed due to a defect in the supplied materials. The warranty covers the roof edge for the lifetime of the roof on which it was originally installed.

PAC-TITE WT EXTENDED FASCIA



PAC-TITE WT Extended Fascia is available in face heights up to 13" and in .050 and .063 aluminum. This eliminates the need for fascia extenders for substantial time and labor savings.

A non-penetrating design eliminates the need for stripping in and heat welding. The possibility of improper flashing procedures or failed adhesives or sealants will not impact the ability of PAC-TITE WT Extended fascia to maintain the watertight integrity of the installation.

The fascia features an extruded aluminum anchor bar to securely terminate the membrane, and to dry-in the roof structure for added installation flexibility.

TWO VERSIONS AVAILABLE

Both versions of PAC-TITE WT Extended Angular Fascia are available and have been extensively tested to meet ANSI-SPRI/FM 4435/ES-1 and FM Approvals: Fully Adhered/Mechanically Attached Single-Ply (FA); and Built-Up/Modified (BUM). Additionally, PAC-TITE WT Extended Fascia is backed by a Lifetime 215 mph wind warranty.

It also features an interlocking, hidden splice plate design under the fascia panels, creating a more attractive finished product. Pre-punched holes lower labor costs by cutting installation time. The slotted fastening holes allow for thermal expansion, and correct fastener placement and spacing.

FULLY ADHERED/MECHANICALLY ATTACHED SINGLE-PLY (FA)

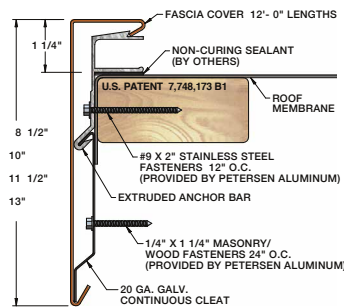

Face Heights	8 1/2"	10"	11 1/2"	13"
--------------	--------	-----	---------	-----

BUILT-UP/MODIFIED (BUM)

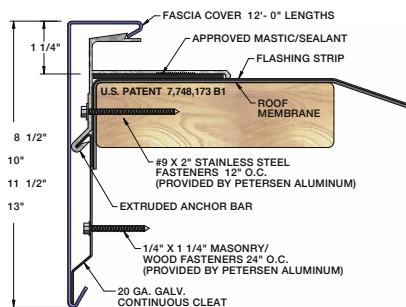

Face Heights	8 1/2"	10"	11 1/2"	13"
--------------	--------	-----	---------	-----

PRODUCT FEATURES

- ▶ Superior, efficient design for ease of installation
- ▶ Pre-punched, slotted holes for precise fastener placement
- ▶ Welded corners and scuppers available
- ▶ Wide variety of colors and finishes
- ▶ Includes anchor bar EPDM splice plates and required fasteners
- ▶ Convenient 12' lengths
- ▶ Reusable and recyclable material
- ▶ Custom and radius capabilities available

MATERIAL

- ▶ 29 Stocked PAC-CLAD Finishes (.050 aluminum)
- ▶ 6 Stocked PAC-CLAD Finishes (.063 aluminum)
- ▶ 16 stocked PAC-CLAD Finishes (22 gauge steel)
- ▶ Mill Finish Aluminum (.050 & .063 aluminum)
- ▶ Clear and Colored Anodized (.050 & .063 aluminum)

TESTING

- ▶ ANSI/SPRI/FM 4435/ES-1 Standard to comply with the International Building Code
- ▶ Factory Mutual approved
- ▶ Miami-Dade approved

WARRANTY

A Lifetime 215 mph warranty is available. It covers replacement or repair of any portion of the roof edge system that has failed due to a defect in the supplied materials. The warranty covers the roof edge for the lifetime of the roof on which it was originally installed.



PAC-TITE WT CANTED FASCIA

The PAC-TITE WT Canted Fascia with Galvanized Waterdam's design keeps the flange out of the waterline. It is available in two profiles, both in .050 and .063 aluminum fascia covers. The standard Canted Fascia version is available in a 5 1/2" face. The PAC-TITE WT Extended Canted Fascia profile is offered in 9" to 13 1/2" face heights to accommodate multiple nailers without the need for a fascia extender.

Heat welding and stripping in are not needed with our non-penetrating design. An extruded aluminum anchor bar securely terminates the membrane.

TWO VERSIONS AVAILABLE

Both versions of PAC-TITE WT Canted Fascia have been extensively tested to meet ANSI-SPRI/FM 4435/ES-1 and FM 1-270 Approvals: WT Canted Fascia with Galvanized Waterdam; and WT Extended Canted Fascia with Galvanized Waterdam. Additionally, PAC-TITE WT Canted Fascia is backed by a Lifetime 215 mph wind warranty to ensure long-term, worry-free performance.

PAC-TITE WT Canted Fascia features pre-punched holes which not only provide quicker installation for labor savings, but are slotted to allow for thermal movement for guaranteed long-term performance. Interlocking, concealed splice plates prevent splice plate migration for a more architecturally pleasing finish.

WT EXTENDED CANTED FASCIA W/ GALVANIZED WATERDAM

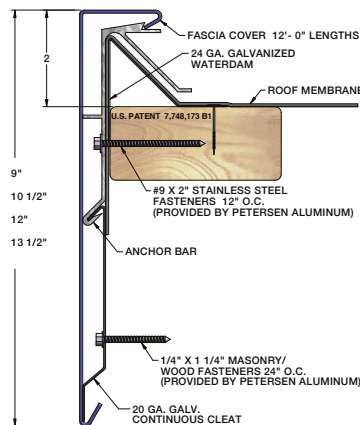
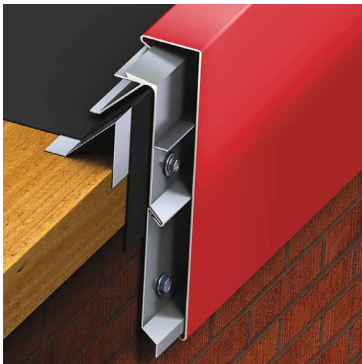

Face Heights	9"	10 1/2"	12"	13 1/2"
Nailer Coverage	1 Nailers	2 Nailers	3 Nailers	4 Nailers

WT CANTED FASCIA W/ GALVANIZED WATERDAM

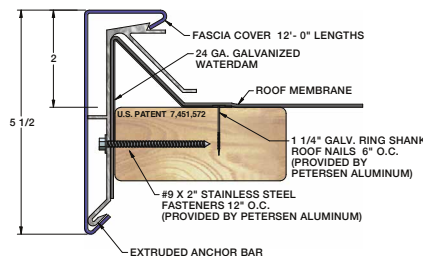

Face Heights	5 1/2"
--------------	--------

PRODUCT FEATURES

- ▶ Unique design keeps flange out of the waterline
- ▶ Snap-on cover eliminates crimping
- ▶ Pre-punched, slotted holes for precise fastener placement
- ▶ Welded corners and scuppers available
- ▶ Wide variety of colors and finishes
- ▶ Convenient 12' lengths
- ▶ Reusable and recyclable material
- ▶ Custom and radius capabilities available

MATERIAL

- ▶ 16 stocked PAC-CLAD Finishes (22 gauge steel)
- ▶ 29 Stocked PAC-CLAD Finishes (.050 aluminum)
- ▶ 6 Stocked PAC-CLAD Finishes (.063 aluminum)
- ▶ Mill Finish Aluminum (.050 & .063 aluminum)
- ▶ Clear and Colored Anodized (.050 & .063 aluminum)

TESTING

- ▶ ANSI/SPRI/FM 4435/ES-1 Standard to comply with the International Building Code
- ▶ Factory Mutual approved

WARRANTY

A Lifetime 215 mph warranty is available. It covers replacement or repair of any portion of the roof edge system that has failed due to a defect in the supplied materials. The warranty covers the roof edge for the lifetime of the roof on which it was originally installed.

PAC-LOC FASCIA

PAC-LOC Fascia Systems provide unmatched uplift protection for single-ply and built up/modified roof systems.

PAC-LOC FASCIA 2000

Ideally suited for all single-ply membrane roofs including stone-ballasted, the two-piece fascia system features a snap-on cover that eliminates field-crimping. PAC-LOC Fascia 2000 offers dual attachment points on both the face and the roof deck to accommodate roof irregularities. The clean design also has no exposed fasteners or cover plates.

PAC-LOC FASCIA 3000

Designed for built-up or modified roof systems, the fascia cover can be installed after the membrane is complete, allowing the contractor to dry-in the building while preventing damage to the finish cover from asphalt splatter.

Both versions feature a non-penetrating design which eliminates the need for stripping in and heat welding, maintaining the watertight integrity of the installation.

PAC-LOC Fascia 2000 and PAC-LOC Fascia 3000 are both tested per ANSI-SPRI/FM 4435/ES-1 standard, and are backed by a 20-Year, 120 mph wind warranty.

PAC-LOC Fascia features pre-punched holes which provide precise fastener location and quicker installation for labor savings. The raised button hole on the vertical face of the waterdam simplifies installation. Interlocking, concealed splice plates prevent splice plate migration.

PAC-LOC FASCIA 2000

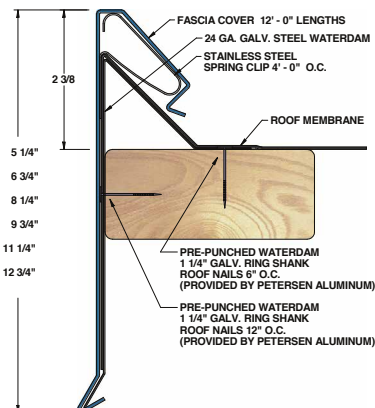
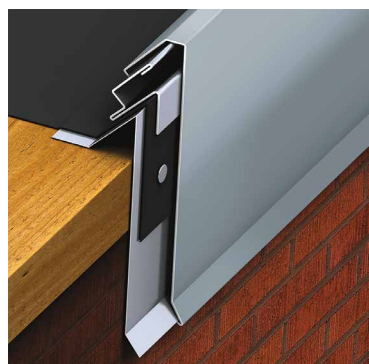

Face Heights	5 1/4"	6 3/4"	8 1/4"	9 3/4"	11 1/4"	12 3/4"
Nailer Coverage	1 Nailers	2 Nailers	3 Nailers	4 Nailers	5 Nailers	6 Nailers

PAC-LOC FASCIA 3000

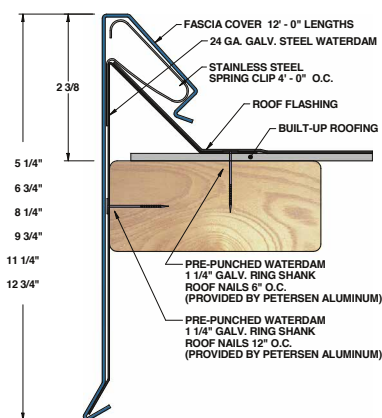
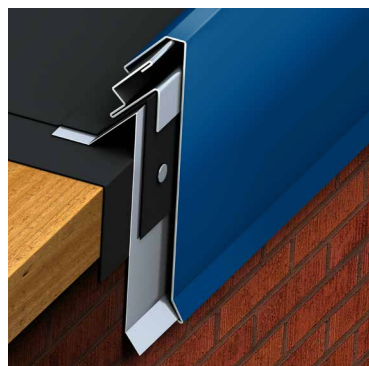

Face Heights	5 1/4"	6 3/4"	8 1/4"	9 3/4"	11 1/4"	12 3/4"
Nailer Coverage	1 Nailers	2 Nailers	3 Nailers	4 Nailers	5 Nailers	6 Nailers

PRODUCT FEATURES

- ▶ Non-penetrating design eliminates stripping-in
- ▶ Pre-punched, slotted holes for precise fastener placement
- ▶ Welded corners and scuppers available
- ▶ Convenient 12' lengths
- ▶ Reusable and recyclable material
- ▶ Custom and radius capabilities available

MATERIAL

- ▶ 43 Stocked PAC-CLAD Finishes (24 gauge steel)
- ▶ 22 Stocked PAC-CLAD Finishes (.040 aluminum)
- ▶ 16 stocked PAC-CLAD Finishes (22 gauge steel)
- ▶ 29 Stocked PAC-CLAD Finishes (.050 aluminum)
- ▶ 6 Stocked PAC-CLAD Finishes (.063 aluminum)
- ▶ Mill Finish Aluminum (.040, .050 & .063 aluminum)
- ▶ Clear and Colored Anodized (.040, .050 & .063 aluminum)

TESTING

- ▶ ANSI/SPRI/FM 4435/ES-1 Standard to comply with the International Building Code

WARRANTY

A 20-Year, 120 mph wind warranty is available on orders to meet a project's specification. It provides a maximum of 20 years, 120 mph coverage for the repair or replacement of any portion of the roof edge system that has failed due to a defect in the supplied material.

PAC Snap Edge meets ANSI-SPRI/FM 4435/ES-1 standards. Installation is simple, with a snap-on cover to eliminate field crimping, and a design that does not require stripping in or heat welding.

THREE VERSIONS AVAILABLE

Three versions of PAC Snap Edge are available in face sizes up to 8": Fully Adhered/Mechanically Attached Single-Ply (FA);

Stone Ballast Single-Ply (SB); and Built-Up/Modified (BUM).

PAC Snap Edge features pre-punched holes which not only provide quicker installation for labor savings, but are slotted to allow for thermal movement for guaranteed long-term performance.

Offering a wide range of factory-fabricated accessories such as miters, scuppers and drainage components, Petersen provides the complete system.

PRODUCT FEATURES

- ▶ Quick lead times to keep projects on schedule
- ▶ Economically priced and easy to install
- ▶ Non-penetrating design eliminates stripping in
- ▶ Pre-punched, slotted holes for precise fastener placement
- ▶ Wide variety of colors and finishes
- ▶ Convenient 12' lengths
- ▶ Reusable and recyclable material

MATERIAL

- ▶ 43 Stocked PAC-CLAD Finishes (24 gauge steel)
- ▶ 22 Stocked PAC-CLAD Finishes (.040 aluminum)
- ▶ 29 Stocked PAC-CLAD Finishes (.050 aluminum)
- ▶ 6 Stocked PAC-CLAD Finishes (.063 aluminum)
- ▶ Mill Finish Aluminum (.040, .050 & .063 aluminum)
- ▶ Clear and Colored Anodized (.040, .050 & .063 aluminum)

TESTING

- ▶ ANSI/SPRI/FM 4435/ES-1 Standard to comply with the International Building Code (FA and BUM only)
- ▶ Factory Mutual approved (FA and BUM only)

WARRANTY

A 5-Year Workmanship Warranty is available. It covers replacement or repair of products that are defective in material or workmanship.

FULLY ADHERED/MECHANICALLY ATTACHED SINGLE-PLY (FA)

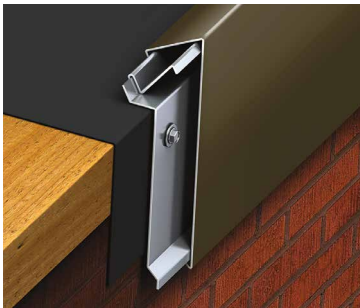

Face Heights	Nailer Coverage
4"	1 Nailers
5"	2 Nailers
6 1/2"	3 Nailers
8"	4 Nailers

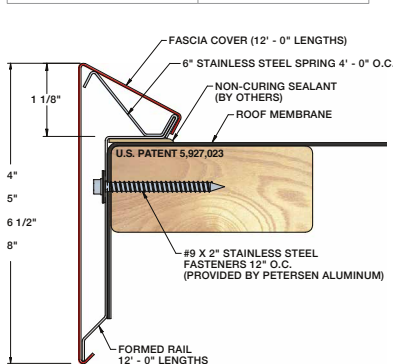

STONE BALLAST SINGLE-PLY (SB)

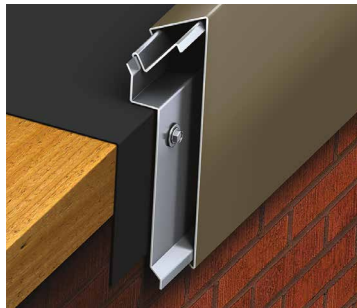

Face Heights	Nailer Coverage
5"	2 Nailers
6 1/2"	3 Nailers
8"	4 Nailers

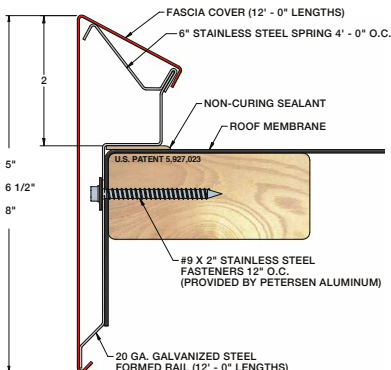

BUILT-UP/MODIFIED (BUM)



Face Heights	Nailer Coverage
5"	2 Nailers
6 1/2"	3 Nailers
8"	4 Nailers

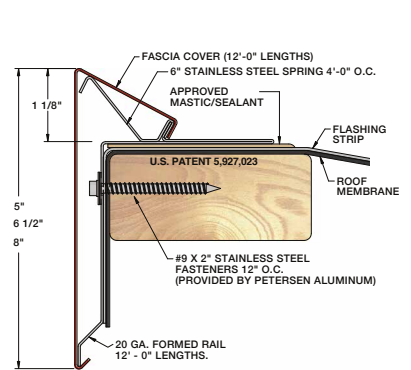

PAC EXTENDED SNAP EDGE FASCIA



PAC Extended Snap Edge Fascia provides the same wind up-lift protection and economy as PAC Snap Edge Fascia but with the design flexibility and cost economies of larger face sizes in .050 and .063 aluminum.

Available in face heights up to 12 1/2", the extended profile allows for extra coverage over multiple nailers while eliminating the use of extenders.

Installation is fast and easy, featuring a snap-on cover to eliminate field crimping and an efficient non-penetrating design that does not require stripping in or heat welding.

TWO VERSIONS AVAILABLE

PAC Extended Snap Edge Fascia comes in: Fully Adhered/Mechanically Attached Single-Ply (FA); and Built-Up/Modified (BUM). PAC Extended Snap Edge Fascia features pre-punched holes which not only provide quicker installation for labor savings, but are slotted to allow for thermal movement for guaranteed long-term performance.

FULLY ADHERED/MECHANICALLY ATTACHED SINGLE-PLY (FA)

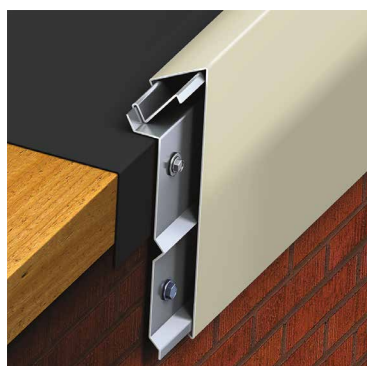

BUILT-UP/MODIFIED (BUM)

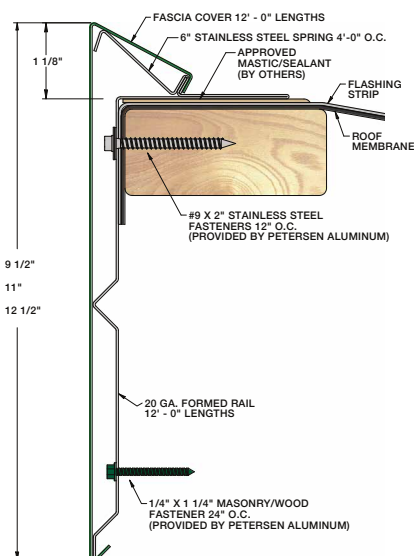
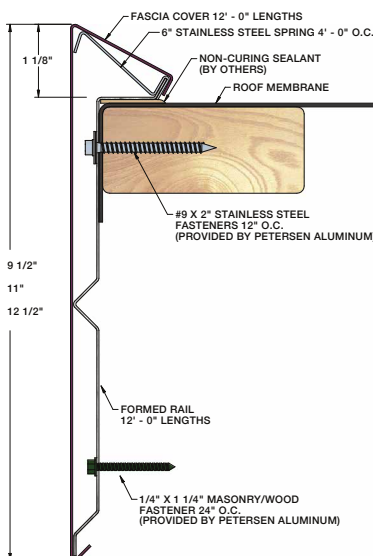

PRODUCT FEATURES

- ▶ Economically priced and easy to install
- ▶ Non-penetrating design eliminates stripping in/heat welding
- ▶ Welded corners and scuppers available
- ▶ Pre-punched, slotted holes for precise fastener placement
- ▶ Wide variety of colors and finishes
- ▶ Convenient 12' lengths
- ▶ Reusable and recyclable material

MATERIAL

- ▶ 29 Stocked PAC-CLAD Finishes (.050 aluminum)
- ▶ 6 Stocked PAC-CLAD Finishes (.063 aluminum)
- ▶ Mill Finish Aluminum (.050 & .063 aluminum)
- ▶ Clear and Colored Anodized (.050 & .063 aluminum)

TESTING

- ▶ ANSI-SPRI/FM 4435/ES-1 Standard to comply with the International Building Code
- ▶ Factory Mutual approved

WARRANTY

A 5-Year Workmanship Warranty is available. It covers replacement or repair of products that are defective in material or workmanship.

Face Heights	9 1/2"	11"	12 1/2"
Nailer Coverage	5 Nailers	6 Nailers	7 Nailers

The PAC-TITE Coping system features concealed 8" wide splice plates that include sealant strips to produce a watertight seal at the joints while allowing for proper thermal movement. Galvanized steel anchor clips have pre-punched holes for proper attachment to the building substrate. Factory-applied, corrosion-resistant stainless steel springs provide long-term positive attachment.

THREE VERSIONS AVAILABLE

Three versions of PAC-TITE Coping are available and have been extensively tested to meet ANSI-SPRI ES-1 and FM Approvals: Tapered; Flat; and Existing Slope with Nailers. PAC-TITE Coping is backed by a 20-Year, 120 mph wind warranty. Factory-fabricated accessories such as quicklocked or welded miters, endwall flashing and endcaps are available. Petersen provides the complete system. Additionally, PAC-TITE coping can meet design requirements including radius, arched and elliptical conditions.

PRODUCT FEATURES

- ▶ Accommodates wall widths up to 34"
- ▶ Efficient design for ease of installation
- ▶ Extensively tested for reliable long-term performance
- ▶ Snap-on design eliminates field-crimping
- ▶ Wide variety of colors and finishes
- ▶ Convenient 12' lengths
- ▶ Reusable and recyclable material
- ▶ Custom and radius capabilities available

MATERIAL

- ▶ 43 Stocked PAC-CLAD Finishes (24 gauge steel)
- ▶ 22 Stocked PAC-CLAD Finishes (.040 aluminum)
- ▶ 16 stocked PAC-CLAD Finishes (22 gauge steel)
- ▶ 29 Stocked PAC-CLAD Finishes (.050 aluminum)
- ▶ 6 Stocked PAC-CLAD Finishes (.063 aluminum)
- ▶ Mill Finish Aluminum (.040, .050 & .063 aluminum)
- ▶ Clear and Colored Anodized (.040, .050 & .063 aluminum)

TESTING

- ▶ ANSI/SPRI/FM 4435/ES-1 Standard to comply with the International Building Code
- ▶ Factory Mutual approved
- ▶ Miami-Dade approved

WARRANTY

A 20-Year, 120 mph wind warranty is available on orders to meet a project's specification. It provides a maximum of 20 years, 120 mph coverage for the repair or replacement of any portion of the roof edge system that has failed due to a defect in the supplied materials.

TAPERED

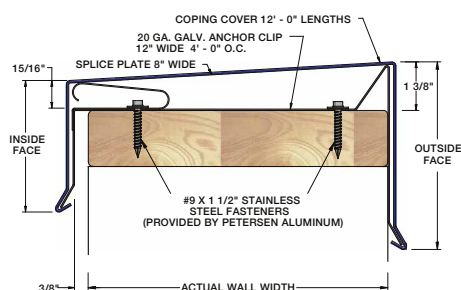

FLAT

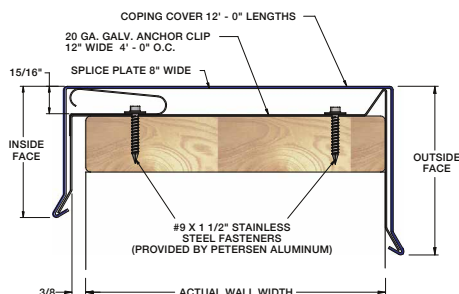

EXISTING SLOPE WITH NAILER

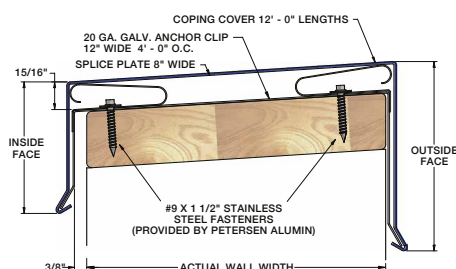

PAC-CONTINUOUS CLEAT COPING

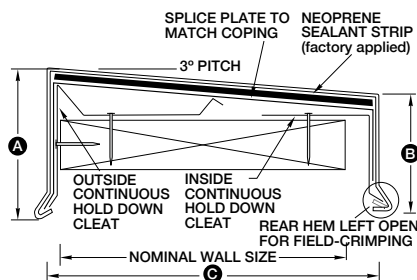

The innovative design of the PAC-Continuous Cleat Coping permits the installation of a sloped coping cap over extra-wide walls. The support of the cleat substantially reduces sagging, which can induce ponding and the possibility of leaks. For further weather-tightness, neoprene strips are factory applied to each hold-down cleat.

Factory-supplied fasteners accompany each coping order to assure proper attachment of the cleats to the wood nailer. Field-crimping on the inside leg of the coping to the inside hold-down cleat completes the installation.



PRODUCT FEATURES

- ▶ Available in up to 12' lengths
- ▶ Full continuous cleat allows for quick installation and low labor costs
- ▶ Superior resistance to high-wind environments
- ▶ Can be custom-fabricated to meet specific job requirements

MATERIAL

- ▶ 43 stocked colors (24 gauge steel)
- ▶ 16 stocked colors (22 gauge steel)
- ▶ 36 stocked colors (.032 aluminum)
- ▶ 22 stocked colors (.040 aluminum)
- ▶ 29 stocked colors (.050 aluminum)
- ▶ 6 stocked colors (.063 aluminum)
- ▶ Galvalume Plus available
- ▶ Mill Finish Aluminum (.040, .050 and .063 aluminum)
- ▶ Clear and Colored Anodized (.040, .050 and .063 aluminum)

TESTING

- ▶ ANSI/SPRI/FM 4435/ES-1 Standard to comply with the International Building Code
- ▶ Factory Mutual approved for wind uplift protection

WARRANTY

A 20-Year, 120 mph wind warranty is available on orders to meet a project's specification. It provides a maximum of 20 years, 120 mph coverage for the repair or replacement of any portion of the roof edge system that has failed due to a defect in the supplied materials.

WIND UPLIFT

Material	Wall Width	FM I-90	FM I-105	FM I-120	FM I-165	FM I-180
24 ga. steel	16" max	✓				
22 ga. steel	16" max	✓	✓			
22 ga. steel	15" max	✓	✓	✓		
.050, .063 Alum.	24" max	✓	✓			
.050, .063 Alum.	16" max	✓	✓	✓	✓	
.050, .063 Alum.	15" max	✓	✓	✓	✓	✓

Virginia Beach Central Library, Virginia Beach, VA
 Architect: City of Virginia Beach
 Installing contractor: Roof Systems of Virginia
 Product: PAC Continuous Cleat Coping
 Color: Stone White

The PAC-TITE Gold coping system provides premium wind uplift protection in parapet wall covering applications, and is ideal for conditions in which slope must be created. The high-performing system features factory-applied stainless steel springs ensuring a long-term, positive attachment for extra stability for the roof system. PAC-TITE Gold coping provides specifiers and contractors unmatched strength, beauty, ease of installation and the ability to meet rigorous testing requirements in perimeter applications.

The superior engineering of PAC-TITE Gold coping ensures an aesthetically pleasing, high-performance installation. The system can meet unique design requirements including radius, arched and elliptical conditions.

PAC-TITE Gold coping offers unlimited flexibility, which can accommodate inside face dimensions of 2.75" to 6", and outside face dimensions of 3" to 12". PAC-TITE Gold coping can be custom-fabricated to meet wider wall widths of more than 16", and has been tested on wall widths up to 32".

PAC-TITE Gold Coping is backed by a Lifetime 215 mph wind warranty to ensure long-term, worry-free performance.

Fabricated from high-quality PAC-CLAD steel and aluminum, PAC-TITE Gold can be specified in a wide range of standard/stocked colors to complement any exterior design scheme.

Offering a wide range of factory-fabricated accessories such as quicklocked or welded miters, Petersen provides the complete system to ensure a clean, sure-fitting product while eliminating the need for field fabrication.

PRODUCT FEATURES

- ▶ Elimination of field-crimping for certain products
- ▶ Wide variety of colors and finishes
- ▶ Compliant with most relevant building codes
- ▶ Superior, efficient design for ease of installation
- ▶ Custom fabricated to the specific job requirements to ensure superior fit
- ▶ Extensively tested for reliable, long-term performance
- ▶ Convenient 12' lengths
- ▶ Reusable and recyclable material
- ▶ Custom and radius capabilities available

MATERIALS

- ▶ 43 Stocked PAC-CLAD Finishes (24 gauge steel)
- ▶ 22 Stocked PAC-CLAD Finishes (.040 aluminum)
- ▶ 29 Stocked PAC-CLAD Finishes (.050 aluminum)
- ▶ 6 Stocked PAC-CLAD Finishes (.063 aluminum)
- ▶ Mill Finish Aluminum (.050 & .063 aluminum)
- ▶ Clear and Colored Anodized (.050 & .063 aluminum)

TESTING

- ▶ ANSI/SPRI/FM 4435/ES-1 Standard to comply with the International Building Code
- ▶ Factory Mutual approved for wind uplift protection
- ▶ Miami-Dade approved

WARRANTY

A Lifetime 215 mph warranty is available. It covers replacement or repair of any portion of the roof edge system that has failed due to a defect in the supplied materials. The warranty covers the roof edge for the lifetime of the roof on which it was originally installed.

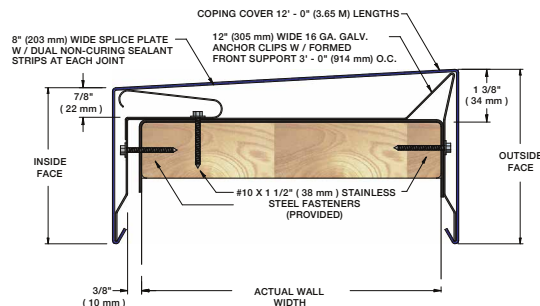

Herrington-Ornelas HealthPark
 Owner: Christus Trinity Mother Frances Health System
 Architect: HC Architects
 General contractor: WRL General Contractors
 Installing contractor: Tyler Roofing
 Profiles: Snap-Clad, HWP, Flush, Custom Coping
 Colors: Champagne, Dark Bronze



University of Texas at Dallas Student Housing Living/Learning Center II, Richardson, TX
 Owner: University of Texas at Dallas
 Architect: Jacobs Engineering Group
 General contractor: Hill & Wilkinson Construction Group
 Installing contractor: American Roofing & Metal Co. Inc.
 Products: Anchor-Tite Coping
 Color: Silver Metallic



- ▶ PAC-TITE ANGULAR FASCIA
- ▶ PAC-TITE WT FASCIA
- ▶ PAC-TITE WT EXTENDED FASCIA
- ▶ PAC-TITE WT CANTED FASCIA
- ▶ PAC-LOC FASCIA
- ▶ PAC SNAP EDGE FASCIA
- ▶ PAC EXTENDED SNAP EDGE FASCIA
- ▶ PAC-TITE COPING
- ▶ PAC-CONTINUOUS CLEAT COPING
- ▶ PAC-TITE GOLD COPING
- ▶ COIL AND FLAT SHEET



HQ: 1005 Tonne Road
 Elk Grove Village, IL 60007
 P: 800-PAC-CLAD
 F: 800-722-7150

9060 Junction Drive
 Annapolis Junction, MD 20701
 P: 800-344-1400
 F: 301-953-7627

10551 PAC Road
 Tyler, TX 75707
 P: 800-441-8661
 F: 903-581-8592

102 Northpoint Parkway
 Acworth, GA 30102
 P: 800-272-4482
 F: 770-420-2533

1800 S. 7th Ave., Suite 130
 Phoenix, AZ 85007
 P: 833-750-1935
 F: 602-254-6504

9817 233rd Ave. E Suite A
 Bonney Lake, WA 98391
 P: 253-501-2450